

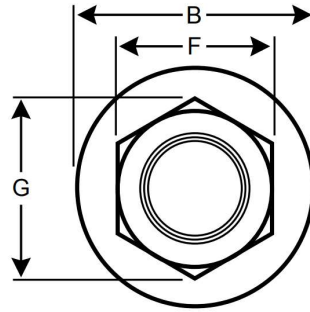

Grade 8 Hex Flange Nuts (Non Lock)

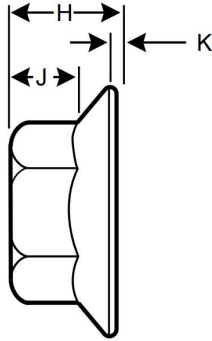

DIMENSIONS
MATERIAL

IFI-145 / ASME B18.2.2
SAE J995 Grade 8

SIZE	WIDTH A/F (F)		WIDTH A/C (G)		FLANGE DIAMETER (B)	
	MAX	MIN	MAX	MIN	MAX	MIN
1/4"	0.438	0.428	0.505	0.488	0.594	0.574
5/16"	0.500	0.489	0.577	0.557	0.680	0.660
3/8"	0.562	0.551	0.650	0.628	0.750	0.728
7/16"	0.688	0.675	0.794	0.768	0.937	0.910
1/2"	0.750	0.736	0.866	0.840	1.031	1.000
5/8"	0.938	0.922	1.083	1.051	1.281	1.248
3/4"	1.125	1.088	1.299	1.240	1.500	1.460

SIZE	FLANGE THICKNESS (K)	WRENCH HEIGHT (J)	NUT THICKNESS (H)	
			MAX	MIN
1/4"	0.040	0.14	0.236	0.222
5/16"	0.040	0.17	0.283	0.268
3/8"	0.040	0.23	0.347	0.330
7/16"	0.040	0.26	0.395	0.375
1/2"	0.050	0.31	0.458	0.437
5/8"	0.050	0.40	0.569	0.545
3/4"	0.060	0.46	0.675	0.627

This specification sheet is not intended to be used in the production of parts. Fast Flange is not liable or responsible for any production errors.