

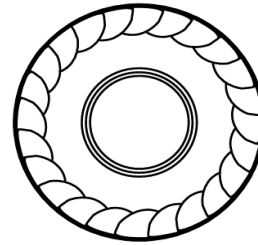

HARDENED HEX SERRATED FLANGE NUTS

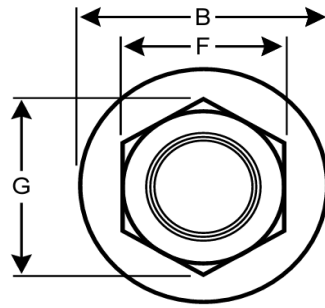
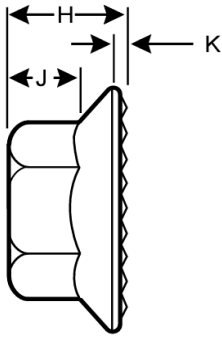

DIMENSIONS

IFI-145 / ASME B18.2.2 - w/ 24 Locking Serrations

MATERIAL

LOW CARBON STEEL - CASE HARDENED

HARDNESS

R15N 79/86

| SIZE BOLT DIA | WIDTH A/F (F) | | WIDTH A/C (G) | | FLANGE DIAMETER (B) | |
|------------------|---------------|-------|---------------|-------|---------------------|-------|
| | MAX | MIN | MAX | MIN | MAX | MIN |
| 1/4" | 0.438 | 0.428 | 0.505 | 0.488 | 0.594 | 0.574 |
| 5/16" | 0.500 | 0.489 | 0.577 | 0.557 | 0.680 | 0.660 |
| 3/8" | 0.562 | 0.551 | 0.650 | 0.628 | 0.750 | 0.728 |
| 7/16" | 0.688 | 0.675 | 0.794 | 0.768 | 0.937 | 0.910 |
| 1/2" | 0.750 | 0.736 | 0.866 | 0.840 | 1.031 | 1.000 |
| 5/8" | 0.938 | 0.922 | 1.083 | 1.051 | 1.281 | 1.248 |

| SIZE BOLT DIA | FLANGE THICKNESS (K) | WRENCH HEIGHT (J) | NUT THICKNESS (H) | |
|------------------|----------------------|-------------------|-------------------|-------|
| | MIN | MIN | MAX | MIN |
| 1/4" | 0.040 | 0.14 | 0.236 | 0.222 |
| 5/16" | 0.040 | 0.17 | 0.283 | 0.268 |
| 3/8" | 0.040 | 0.23 | 0.347 | 0.330 |
| 7/16" | 0.040 | 0.26 | 0.395 | 0.375 |
| 1/2" | 0.050 | 0.31 | 0.458 | 0.437 |
| 5/8" | 0.050 | 0.40 | 0.569 | 0.545 |

This specification sheet is not intended to be used in the production of parts. Fast Flange is not liable or responsible for any production errors.